

# INSTALLATION INSTRUCTIONS



Fire-Cryer Plus Voice Enhanced Sounder (Part Code FC3/A/\*/\*/\*)

## General

A Voice Enhanced Sounder designed for environments requiring tones and speech to alert the building occupants of a Fire Emergency.

## Specification

Tone Output / Voice (Max)	100dB(A) / 95dB(a) at 1 metre
Volume Adjustment	18dB
Current.(Sounder only)	20mA Average/ 27mA Peak
(Sounder+2 Cd Strobe)	26mA Average/ 33mA Peak
(Sounder+6 Cd Strobe)	52mA Average/ 60mA Peak
Voltage Range	20Vdc - 28Vdc (24Vdc Nominal)
Ingress Protection	IP45 / IP66 (When used with deep base)
Cable entries	4x M20 (Deep Base) / 2x M20 (Shallow base)
Terminals	0.5mm <sup>2</sup> - 2.5mm <sup>2</sup> cables
Operating Temperature	-25°C to +70°C

**Note:** Specification above based upon Vimpex Message Pack A (Fire)

## Installation, Message Selection & Volume Control

Mount backbox to building substrate. Once securely fastened to wall/ sub-  
strate fit appropriate cable entry glands (If required by IP / regulation)  
prior to installing cables. Connect the field wiring as per the diagram  
shown and ensure DIL switches are configured correctly before securing  
the front horn with the two screws provided. (Ensure seal is fitted on deep  
base)

## Mechanical Information

Drawings show unit with strobe and deep base fitted.

Dimensions (mm)

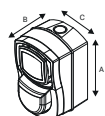
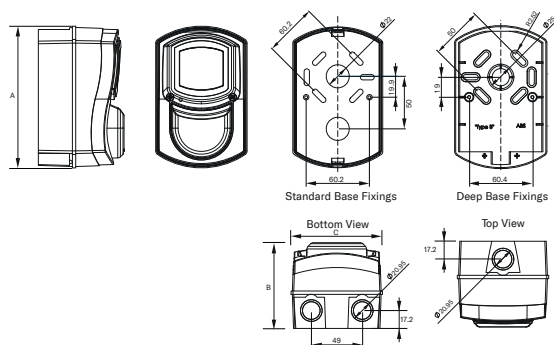

Overall Dimensions				
	Standard Base	Standard Base + Strobe	Deep Base	Deep Base + Strobe
A	134.0	134.0	136.5	136.5
B	56.9	59.9	79.6	82.6
C	85.6	85.6	88.0	88.0



# INSTALLATION INSTRUCTIONS

Fire-Cryer Plus Voice Enhanced Sounder (Part Code FC3/A/\*/\*/\*)

## General

A Voice Enhanced Sounder designed for environments requiring tones and speech to alert the building occupants of a Fire Emergency.

## Specification

Tone Output / Voice (Max)	100dB(A) / 95dB(a) at 1 metre
Volume Adjustment	18dB
Current.(Sounder only)	20mA Average/ 27mA Peak
(Sounder+2 Cd Strobe)	26mA Average/ 33mA Peak
(Sounder+6 Cd Strobe)	52mA Average/ 60mA Peak
Voltage Range	20Vdc - 28Vdc (24Vdc Nominal)
Ingress Protection	IP45 / IP66 (When used with deep base)
Cable entries	4x M20 (Deep Base) / 2x M20 (Shallow base)
Terminals	0.5mm <sup>2</sup> - 2.5mm <sup>2</sup> cables
Operating Temperature	-25°C to +70°C

**Note:** Specification above based upon Vimpex Message Pack A (Fire)

## Installation, Message Selection & Volume Control

Mount backbox to building substrate. Once securely fastened to wall/ sub-  
strate fit appropriate cable entry glands (If required by IP / regulation)  
prior to installing cables. Connect the field wiring as per the diagram  
shown and ensure DIL switches are configured correctly before securing  
the front horn with the two screws provided. (Ensure seal is fitted on deep  
base)

## Mechanical Information

Drawings show unit with strobe and deep base fitted.

Dimensions (mm)

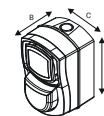
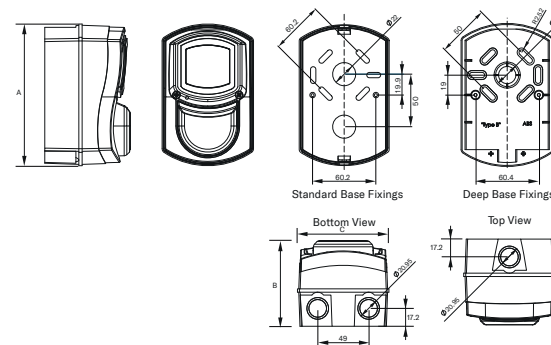

Overall Dimensions				
	Standard Base	Standard Base + Strobe	Deep Base	Deep Base + Strobe
A	134.0	134.0	136.5	136.5
B	56.9	59.9	79.6	82.6
C	85.6	85.6	88.0	88.0

## INSTALLATION INSTRUCTIONS

Fire-Cryer Plus Voice Enhanced Sounder (Part Code FC3/A/\*/\*/\*)

### Strobe Output

Strobe (if fitted)	SW3
Normal Output	OFF
High Output	ON

Note: If Strobe is not fitted then Switch 3 must be set to the OFF position.

Note: Switch 8 is not used and must be set to OFF position.

Volume Settings	SW1	SW2
0db (Max Volume)	OFF	ON
-6dB	OFF	OFF
-12dB	ON	ON
-18dB (Min Volume)	ON	OFF

### Connection Diagram

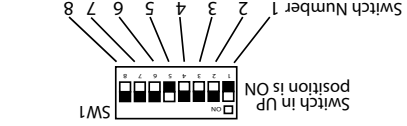
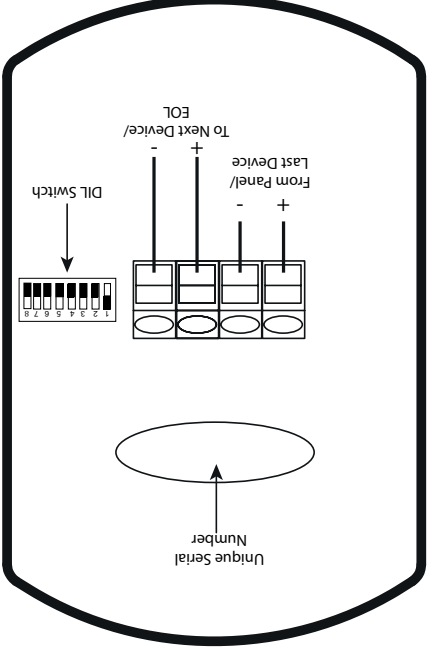

**Please note:** If a standard sounder circuit is connected to the product it will only play a single pre-stored messages 1-7, depending upon DIL switch setting.

\*If used in conjunction with a VM/C/xx/xx/xx the switches MUST be set for 'Multi-Message Use';

## INSTALLATION INSTRUCTIONS

Fire-Cryer Plus Voice Enhanced Sounder (Part Code FC3/A/\*/\*/\*)

### Volume Control

### Strobe Output

Strobe (if fitted)	SW3
Normal Output	OFF
High Output	ON

Note: If Strobe is not fitted then Switch 3 must be set to the OFF position.

\*If used in conjunction with a VM/C/xx/xx/xx the switches MUST be set for 'Multi-Message Use';

**Please note:** If a standard sounder circuit is connected to the product it will only play a single pre-stored messages 1-7, depending upon DIL switch setting.

### Volume Control

Volume Settings	SW1	SW2
0db (Max Volume)	OFF	ON
-6dB	OFF	OFF
-12dB	ON	ON
-18dB (Min Volume)	ON	OFF

Note: Switch 8 is not used and must be set to OFF position.

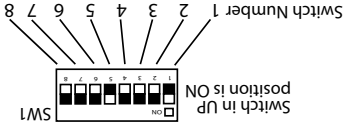
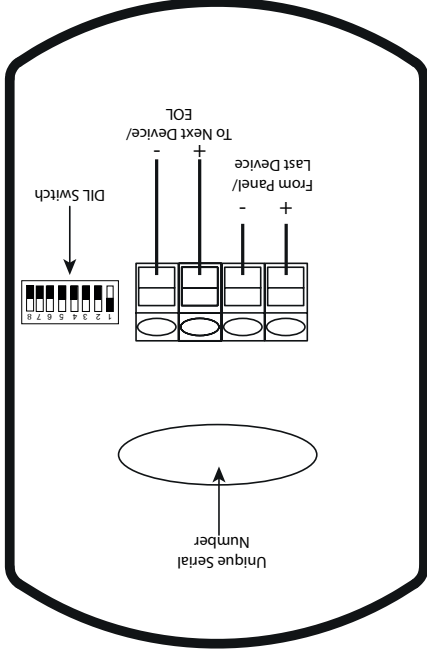

**Please note:** If a standard sounder circuit is connected to the product it will only play a single pre-stored messages 1-7, depending upon DIL switch setting.

\*If used in conjunction with a VM/C/xx/xx/xx the switches MUST be set for 'Multi-Message Use';

## INSTALLATION INSTRUCTIONS

Fire-Cryer Plus Voice Enhanced Sounder (Part Code FC3/A/\*/\*/\*)

### Strobe Output

Strobe (if fitted)	SW3
Normal Output	OFF
High Output	ON

Note: If Strobe is not fitted then Switch 3 must be set to the OFF position.

\*If used in conjunction with a VM/C/xx/xx/xx the switches MUST be set for 'Multi-Message Use';

**Please note:** If a standard sounder circuit is connected to the product it will only play a single pre-stored messages 1-7, depending upon DIL switch setting.

Message Selection*	SW4	SW5	SW6	SW7
Message 1	OFF	OFF	OFF	OFF
Message 2	OFF	ON	OFF	OFF
Message 3	ON	ON	OFF	OFF
Message 4	OFF	OFF	ON	OFF
Message 5	ON	OFF	ON	OFF
Message 6	OFF	ON	ON	OFF
Message 7	ON	ON	ON	OFF
Message 8	OFF	OFF	OFF	ON
Message 9	ON	OFF	OFF	ON

Vimpex Limited  
Star Lane, Great Wakering  
Essex SS3 0PJ  
UK  
+44(0) 1702 216 999  
sales@vimpex.co.uk  
web: www.vimpex.co.uk

Vimpex Sweden AB  
Mekanikervägen 6  
de Gouwé 28  
Dronsten, 8253 PA  
Dublin. D6W FN23  
Ireland  
+44(0) 1702 216 999  
sales@vimpex.co.uk  
web: www.vimpex.co.uk

Message Selection*	SW4	SW5	SW6	SW7
Message 1	OFF	OFF	OFF	OFF
Message 2	OFF	ON	OFF	OFF
Message 3	ON	ON	OFF	OFF
Message 4	OFF	OFF	ON	OFF
Message 5	ON	OFF	ON	OFF
Message 6	OFF	ON	ON	OFF
Message 7	ON	ON	ON	OFF
Message 8	OFF	OFF	OFF	ON
Message 9	ON	OFF	OFF	ON

Vimpex Limited  
Star Lane, Great Wakering  
Essex SS3 0PJ  
UK  
+44(0) 1702 216 999  
sales@vimpex.co.uk  
web: www.vimpex.co.uk

Vimpex Sweden AB  
Mekanikervägen 6  
de Gouwé 28  
Dronsten, 8253 PA  
Dublin. D6W FN23  
Ireland  
+44(0) 1702 216 999  
sales@vimpex.co.uk  
web: www.vimpex.co.uk